

PLAN	KCC 2A
TITLE	Amended Block Plan - Dwelling
SITE	Land at Caps Lane
CLIENT	Mr and Mrs Wilson
NUMBER	KCC1704/20 03/15 cdb
DATE	March 2015
SCALE	1:500 at A3

KERNON COUNTRYSIDE CONSULTANTS LTD
 Greenacres Barn, Stoke Common Lane, Purton Stoke, Swindon
 SN5 4LL Tel 01753 771333 Email: info@kernon.co.uk
 This plan is reproduced from the Ordnance Survey
 under copyright licence 100015226



FD - Front French Doors
FW - Front Windows

Solitaire Super

Layouts - 12 Wide

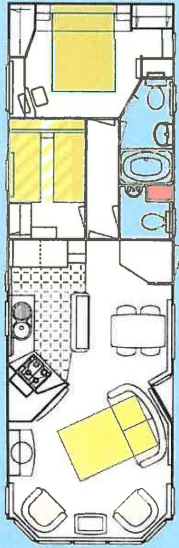

38/2 Bedroom
Body Length (inc. bay) - 11.95m (39'-2 1/2")
Body Width - 3.69m (12'-1")

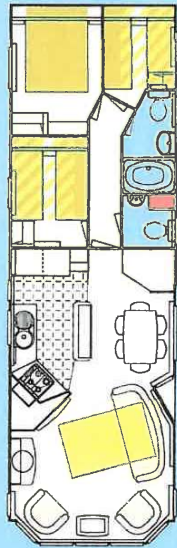

38/3 Bedroom
Body Length (inc. bay) - 11.95m (39'-2 1/2")
Body Width - 3.69m (12'-1")

Features

- Pitched roof
- Open vaulted ceiling
- Plastisol coated steel pantile roof
- Double glazed PVCU exterior door and windows, featuring night ventilation position
- Domestic style central heating system including combi boiler
- Under floor insulation
- Lagged water pipes
- Pre- galvanised chassis
- Extra insulation
- Underlay fitted beneath all carpets
- Domestic quality three piece suite with foldout sprung double bed
- Embossed six panel, woodgrain effect, flush internal doors
- Modern quality cabinet work with textured glazed panels
- Stylish electric fire with contemporary surround
- Framed pictures to lounge and main bedrooms
- Fully lined curtains to lounge, entrance door and bedrooms
- Volles to lounge area and net curtains to bedrooms
- T.V. point
- Freestanding glass panelled dining table and upholstered chairs
- Venetian blind to kitchen and bathroom
- Quality stainless steel hob and high level oven with grill
- Stainless steel recirculating cooker hood
- 18/8 quality, double radius, linen finish, stainless steel sink
- Integrated fridge and freezer
- Chrome wire storage basket and wine rack to kitchen
- Deluxe metal drawer system
- Ample storage space for household items
- Shower socket
- Coordinating bed covers and pillowcases
- Interior sprung mattresses with damask ticking
- Metal freestanding sprung beds to main and twin bedrooms
- Twin beds combine to make a double bed if required
- Under bed storage in all bedrooms
- High quality ceramic toilet suite
- Stylish bathroom fittings
- Tub style bath with shower, sliding glazed door and thermostatic shower mixer
- Coordinating doormat
- Exterior light
- Colour coordinated downpipes
- Retractable tow bar
- Aluminium cladding
- Smoke alarm

Options for:

- Double glazed PVCU front French doors

Atlas reserves the right to change any materials, fittings etc., shown in this brochure at any time and without prior notice to comply with all relevant British Standards and Codes of Practice as required by the National Caravan Council. To use an Atlas Caravan Holiday Home, it will need to be correctly fitted, have steps or other means of access to suit the required power, drainage, mains water at a pressure to suit the appliances and a waste water/sewage outlet. To match patterns precisely on some wallboards and fabrics. Any Park Operator, anywhere in the UK, can carry out



PLAN TITLE	KCC 4 Example Elevations and Floor Plan - Mobile Home
SITE	Land at Stonehill
CLIENT	Mr and Mrs S Philipott
NUMBER	KCC1183/11
DATE	May 2011
SCALE	Not to scale

KERNON COUNTRYSIDE CONSULTANTS
Brook Cottage, Purton Stoke, Swindon SN6 4JE
Tel 01793 771333 Fax 01793 778384



Atlas Caravan Com
Wiltshire Road, Huddersfield
Telephone No. 01482 562101. Fax
www.atlas-caravans



Solitaire Super

FD - Front French Doors
FW - Front Windows

T.V., Video and all ornaments are for display only.

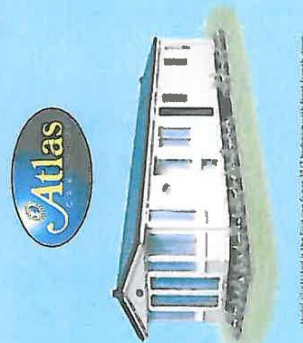
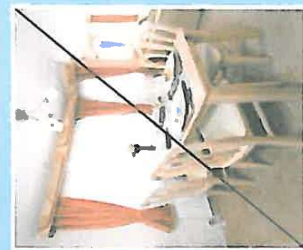

Model illustrated is the Solitaire Super 38/2 bedroom with front French doors.

This page is intentionally left blank